

INSTALLATION AND USER INSTRUCTIONS

VISTA

06.50-SERIES

FOR H2 VEHICLES ON A X290 PLATFORM
(FIAT DUCATO, PEUGEOT BOXER, CITROËN JUMPER)



TABLE OF CONTENTS

1	PREFACE	2
1.1	Description of the user	2
1.2	Conventions used in this manual	2
1.3	Explanation of safety warnings	2
1.4	Retaining instructions	2
1.5	Obtaining documentation and information	2
2	DESCRIPTION OF THE PRODUCT	3
2.1	Intended use and reasonably foreseeable misuse	3
2.2	System overview	3
3	SAFETY INSTRUCTIONS	3
3.1	How to install the product safely	3
3.2	How to use the product safely	4
3.3	Potential health consequences	4
3.4	Personal Protective Equipment	4
4	HOW TO INSTALL THE PRODUCT	4
5	HOW TO USE THE PRODUCT	6
5.1	How to operate the window	6
5.2	How to operate the pleated blind system	6
6	HOW TO MAINTAIN THE PRODUCT	7
6.1	Planned maintenance and inspection	7
6.2	How to perform maintenance tasks	7
	APPENDIX	8
I.	Technical data	8
II.	Product elements	8

1 PREFACE

1.1 DESCRIPTION OF THE USER

This document is intended for the installer of the Vista. The installer can be described as any person who interacts directly with the product during installation. The installation of the product shall only be carried out by a professional mechanic who has read and understood these instructions, is familiar with installing similar products, is aware of all possible dangers and acts accordingly. Persons who are not professionally trained for window installation should not attempt to install the window themselves.

1.2 CONVENTIONS USED IN THIS MANUAL

The following style conventions are used in this document:

Bold

Names of product elements, commands, options, processes, services, and utilities.

Italic

Publication titles, referenced in text, emphasis

1.3 EXPLANATION OF SAFETY WARNINGS

⚠ WARNING

WARNING! Indicates a hazard with a medium level of risk which, if not avoided, could result in death or serious injury.

⚠ CAUTION

CAUTION! Indicates a hazard with a low level of risk which, if not avoided, could result in minor or moderate injury.

NOTICE

NOTICE Indicates information considered important, but not hazard-related.

1.4 RETAINING INSTRUCTIONS

Keep all safety information and instructions for future reference and pass them on to subsequent users of the product.

The product shall only be used for applications as described by the manufacturer. All other applications are unprofessional and considered dangerous. The manufacturer cannot be held liable for damage resulting from errors, unintended or unprofessional use of the product.

1.5 OBTAINING DOCUMENTATION AND INFORMATION

The latest version of the installation manual, safety instructions, technical information and other product documentation can be requested at the following address: sales@polyplastic.nl.

2 DESCRIPTION OF THE PRODUCT

2.1 INTENDED USE AND REASONABLY FORESEEABLE MISUSE

The Vista is intended to be used as a roof window solution for an H2 vehicle with an X290 platform (Fiat Ducato, Peugeot Boxer, Citroën Jumper). It shall not be used on any other location on the vehicle other than indicated by Polyplastic.

Polyplastic is not responsible for the structural integrity of the vehicle the Vista is installed on.

The Vista shall not be installed or used in any other way than described in these installation instructions. Any other way than described in these instructions is considered as unintended use. Failure to observe this warning may cause permanent damage to the Vista, injury to other persons or the installer and void any warranty.

2.2 SYSTEM OVERVIEW

The Vista is a roof window system which comes pre-assembled. In this manual the word "Vista" refers to the entire window system.

The Vista comes in two variations, a solution with a fixed roof window and a solution with a window that can be opened.

The Vista consists of an **adapter** ⑥ which is fixed to the outside of the vehicle with glue and a mechanical fixation on the inside of the vehicle. The mechanical fixation consists of four **fixation cones** ⑥ and four **screws** ①. The **double-pane acrylic window** ③ is connected to the adapter with a hinge bar. A **rubber seal** ⑦ ensures a watertight solution. The version which can be opened contains two **stays** ② and five **catches** ④ and **lockplates** ⑤ which are used to lock the window. The stays secure the desired opening of the window, while the catches and the lockplates secure the window when it is closed. On both versions the product is equipped with a **pleated blind system** ⑨ which can be used as a blackout and an insect screen.

Polyplastic advises to create the wall aperture in the vehicle using a jig. This jig can be drawn up using the 3D data made available by Polyplastic.

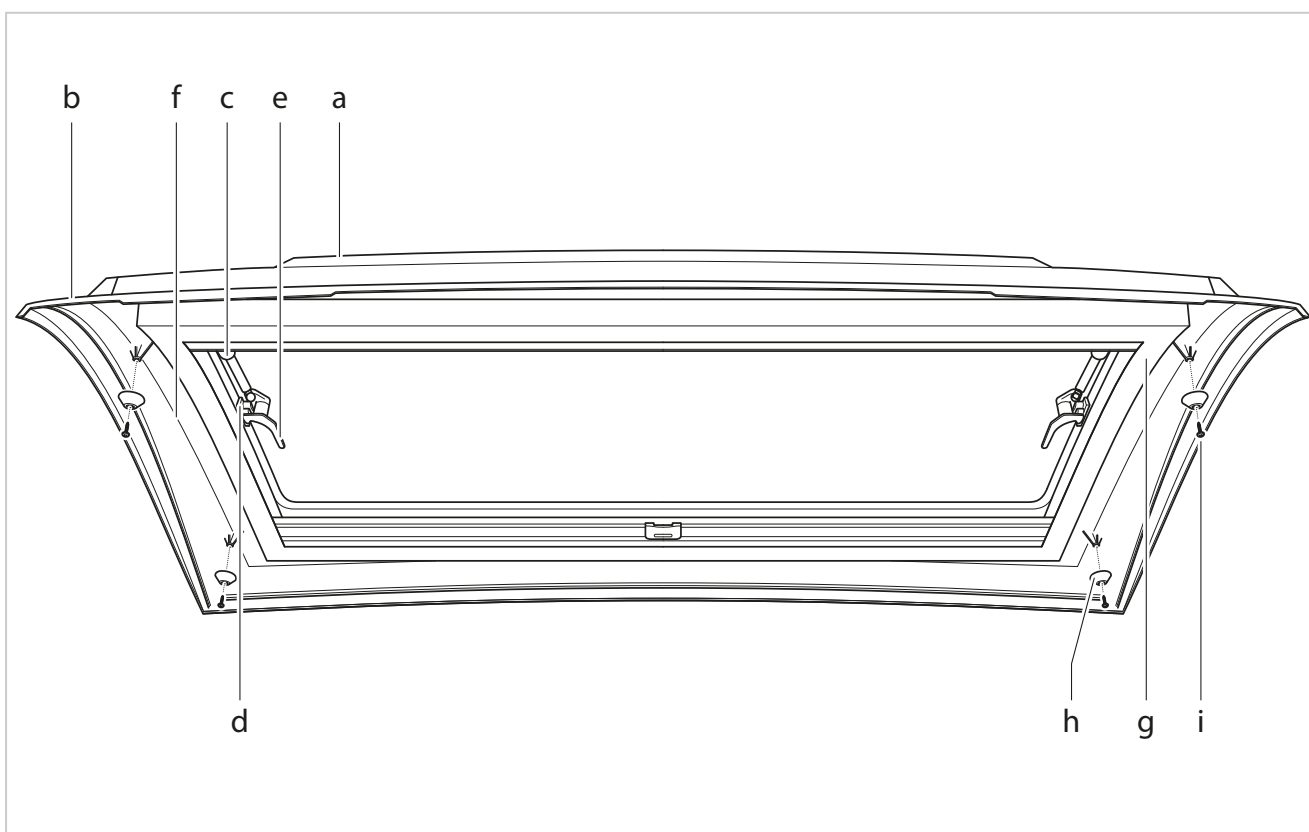

3 SAFETY INSTRUCTIONS

⚠ WARNING Read and understand these instructions before installing and using this product. Failure to do so can result in serious damage and/or injury.

3.1 HOW TO INSTALL THE PRODUCT SAFELY

- Make sure that each person who installs the product has read these warnings and instructions and follows them.
- Never try to install or repair a Vista if you do not have the necessary technical skills and the technical documentation, tools and equipment available. Failure to do so will void the warranty.
- The manufacturer is not liable for cases of material damage or personal injury caused by incorrect handling or non-compliance with the safety instructions. In such cases, any warranty will be voided.
- Make sure to follow relevant local safety and hygiene guidelines before you install the product.
- Polyplastic is not responsible for damages occurring due to incorrect installation.
- Polyplastic is not responsible for technical modifications to the vehicle in order to install the Vista.
- Never make alterations to the product without written permission from Polyplastic.
- The Vista shall be installed with at least two people.
- Polyplastic is not responsible for the structural integrity of the vehicle the Vista is installed on.
- Only genuine Polyplastic parts shall be used. For more information, please refer to the accessories catalogue and the APPENDIX Serviceable parts.

3.2 HOW TO USE THE PRODUCT SAFELY

- Always check the window is closed properly before driving. Do not drive with the window open (this includes the ventilation position).
- Do not exceed the maximum speed of 160 km/h when driving a vehicle with an installed Vista.
- Always check that the window is intact before driving.
- Do not transport the vehicle backwards with an installed Vista.
- In case of a defect or damage, do not install the product. Follow the warranty procedure (www.polyplastic.nl).
- Never open the window with strong winds and rain, to prevent injuries or damage.
- Always remove an accumulation of snow to prevent damage to the window.
- Always remove an accumulation of material (for example leaves) from the system to prevent water ingress and malfunction of the product.

3.3 POTENTIAL HEALTH CONSEQUENCES

Before using any specialized tools, make sure to know all rules and regulations for this equipment in your country. Substances like glue, initiator or cleaning agent can be inflammable or harmful to your health when being touched or inhaled. Carefully follow the instructions on the package of the product. Check and act according to the laws and regulations in your country with reference to the use of this substance. Wear a respirator mask, make sure that the workplace is well ventilated and that there is a good functioning aspiration system.

3.4 PERSONAL PROTECTIVE EQUIPMENT

⚠ CAUTION Always wear personal protective equipment when installing a Vista.

Personal protective equipment shall include the following items:

- Ear protection
- Safety shoes
- Safety goggles
- Protective gloves
- Respirator mask (when there is no proper air extraction system or ventilation in the working environment)

4 HOW TO INSTALL THE PRODUCT

⚠ WARNING

- The type of glue and glue process are crucial for a proper installation of the Vista. Polyplastic therefore advises establishing an installation procedure in cooperation with a glue expert. This process needs to be documented, followed and the result needs to be validated. Polyplastic strongly recommends using a flexible, 2K (boosted) glue.
- These instructions explain how to install the Vista inside an aperture. This document does not describe how to create and correctly finish the aperture itself. This is the responsibility of a skilled professional. Polyplastic advises the use of a jig for constant quality.

Required tools and materials:

- Electric drill
- Fine grade of sandpaper
- Lashing straps (*optional*)
- Clamps (*optional*)
- Primer (*optional*)
- Glue
- Cleaning liquid (*not harmful to polyurethane*)
- Tools to apply glue
- Wipes for cleaning and to remove excessive sealant

Prerequisites:

- A correctly sized and finished aperture in an H2 vehicle with an X290 platform (Fiat Ducato, Peugeot Boxer, Citroën Jumper) (*drawing available at Polyplastic*).

To install a Vista:

1. Check that your delivery contains all the parts as specified on your order sheet.
NOTICE Contact your reseller if your order is incomplete or incorrect.
2. Take the Vista from the packaging.
3. Clean and degrease the glue channel of the adapter ⑥, with a neutral degreasing detergent.

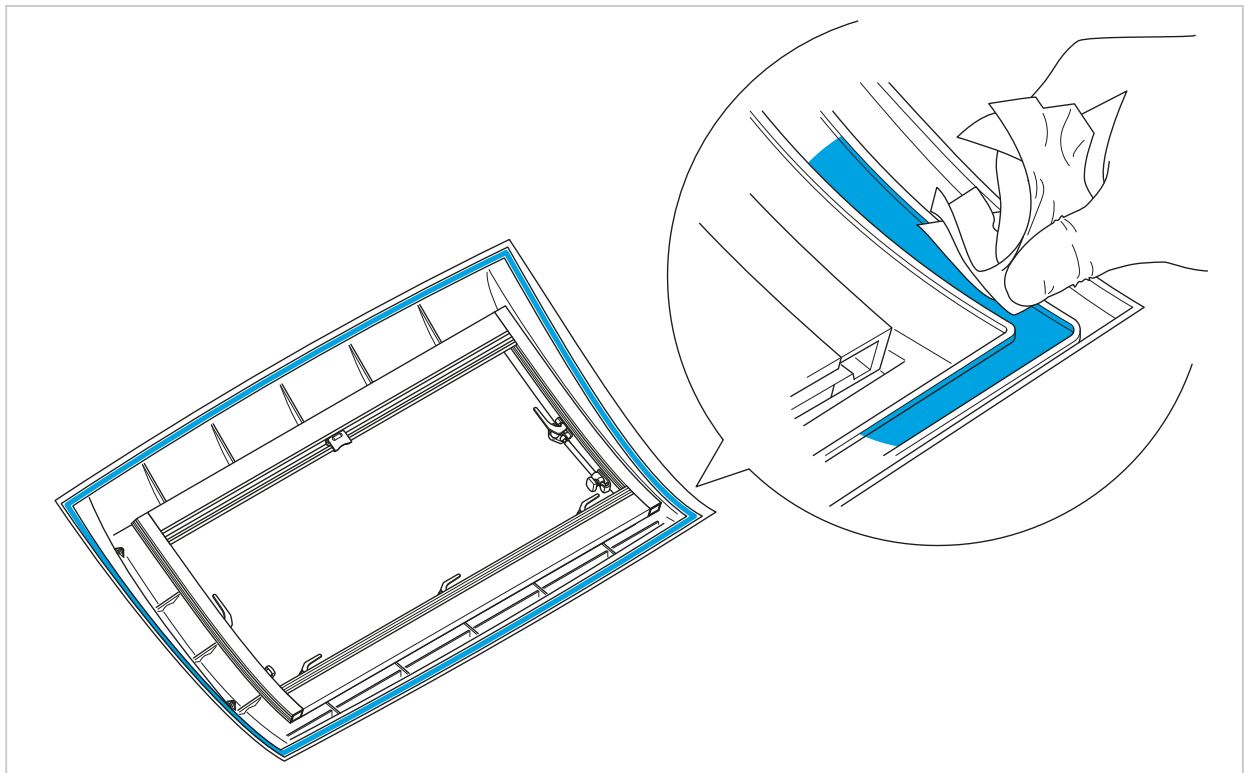

4. Sand the **glue channel** of the **adapter** ⑥ lightly, with a fine grade of sandpaper.
5. Clean and degrease the **glue channel** of the **adapter** ⑥ again.
NOTICE Make sure the glue channel is dry, grease free and free of sanding dust.
6. Clean and degrease the area around the aperture in the vehicle, with a neutral degreasing detergent.
NOTICE Make sure the treated area is dry, grease and dust free.

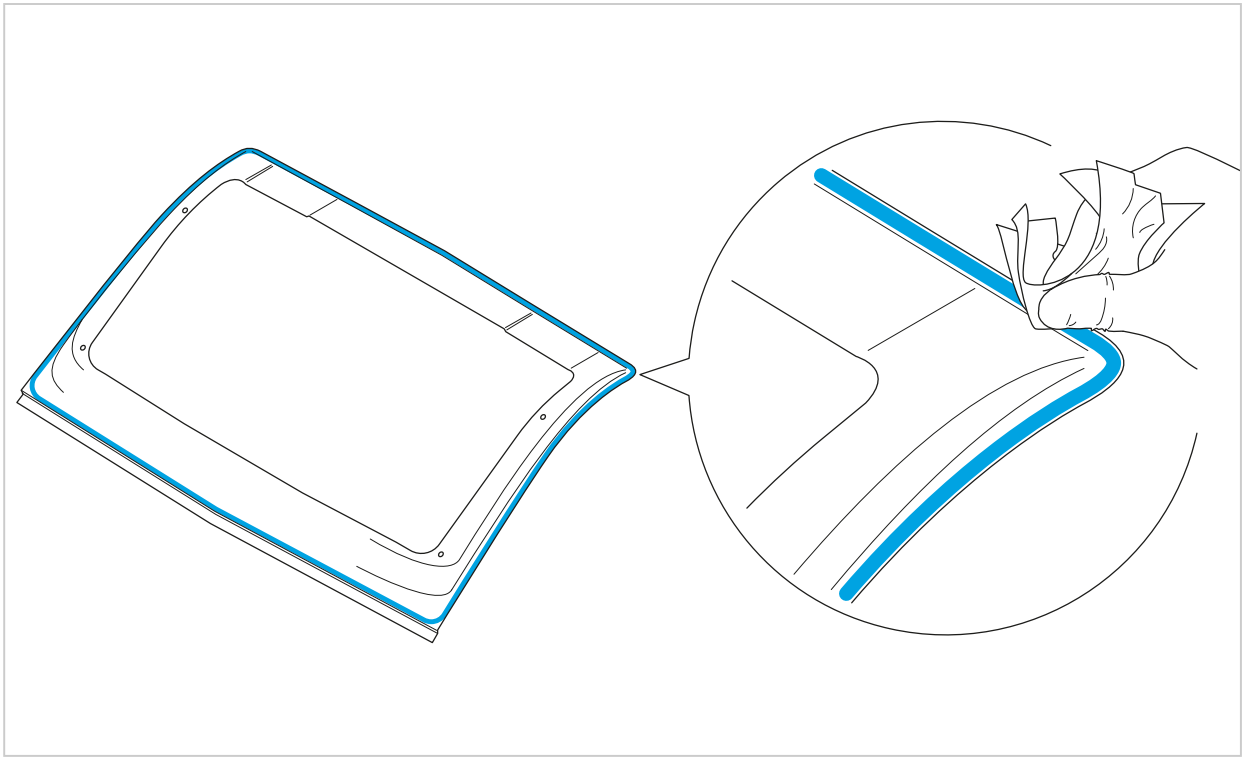

EN

7. **OPTIONAL** when your glue expert prescribes the use of a primer, apply it inside the **glue channel** of the **adapter** ⑥ and around the aperture in the vehicle. If you are not using a primer continue to *step 8*.
8. Apply the glue inside the **glue channel** of the **adapter** ⑥ in a continuous loop. Make sure enough glue is added to ensure a proper glue connection. Consult the instructions provided with the glue you are using.

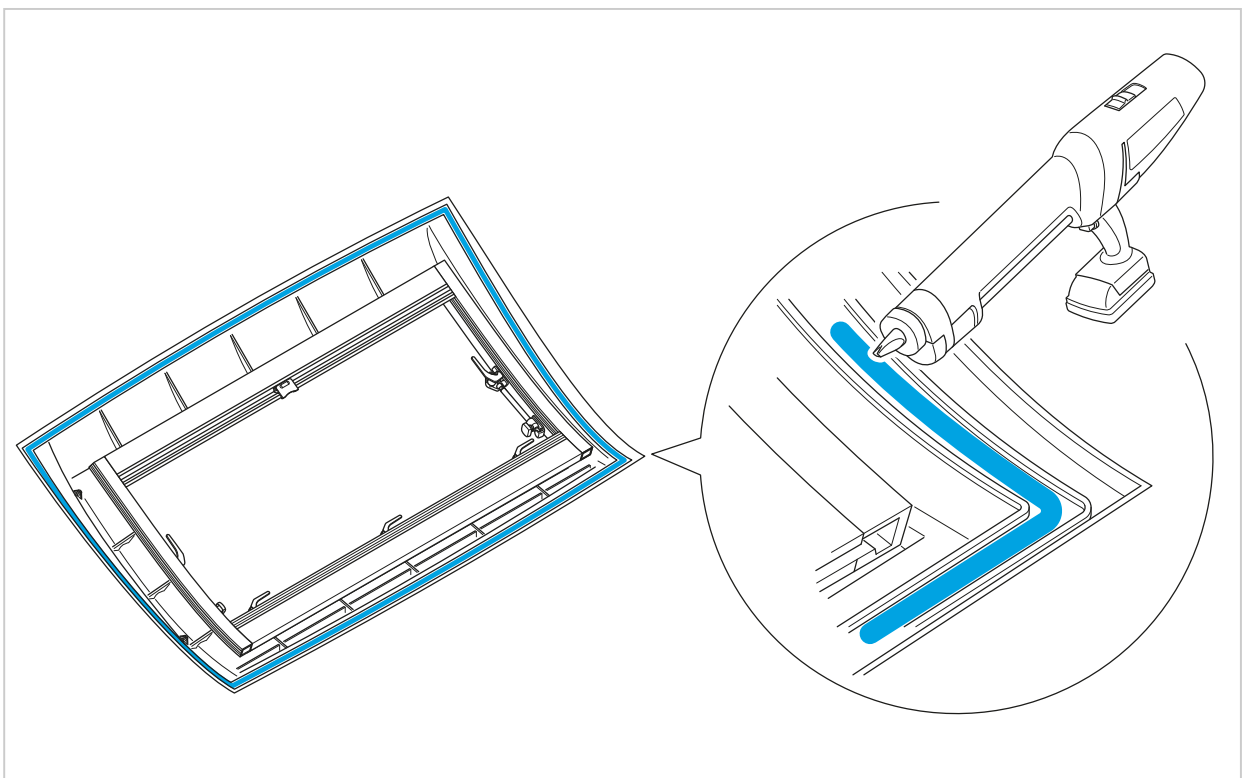

9. Place the **Vista** in the aperture of the vehicle.
NOTICE Make sure the **screwing domes** of the **adapter** ⑥ protrude through the holes of the aperture.

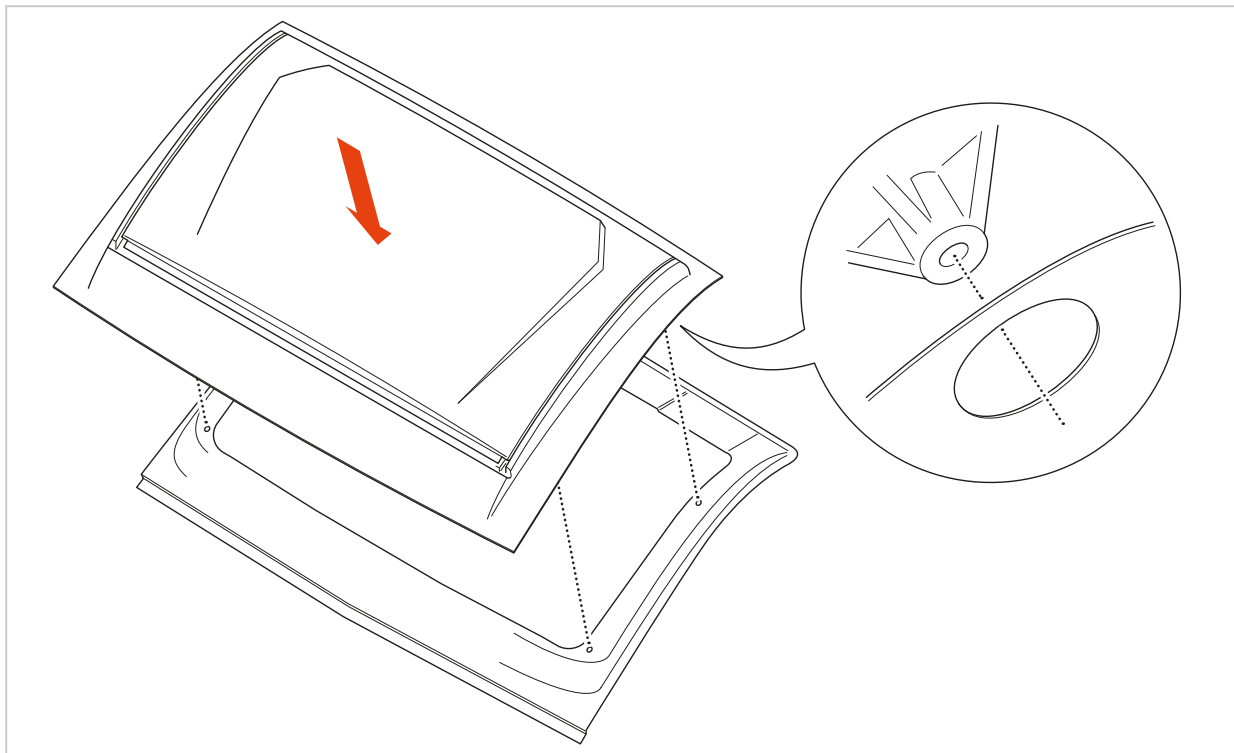

10. Place a **fixation cone** ⑦ over a **screwing dome** of the **adapter** ⑥ on the inside of the vehicle. Fix it with a **screw** ⑧. Do this for all four screwing domes.
NOTICE Use a torque of .. N. If necessary, increase torque step by step.

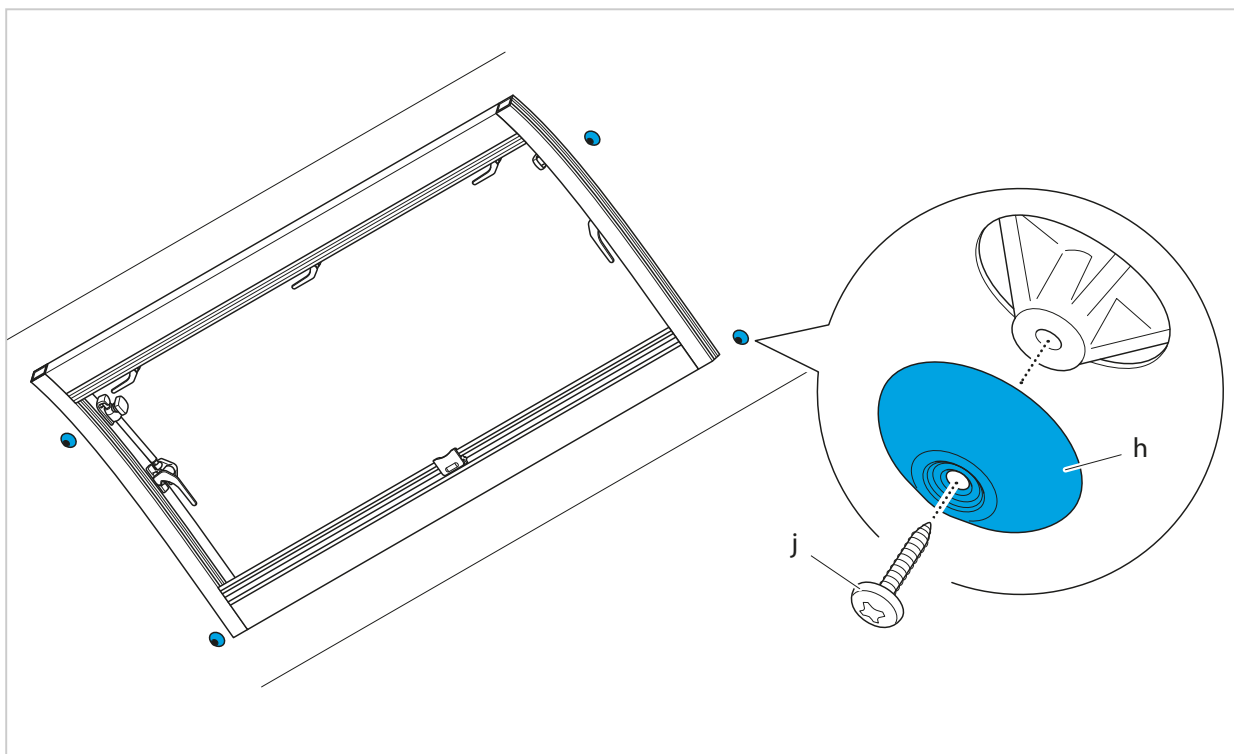

11. Apply pressure on the glue area of the **adapter** ⑥ to make sure the glue is equally divided and the product follows the vehicle's shape. Make sure the force applied is evenly distributed over the glue area.
NOTICE Never put pressure on the **double-pane acrylic window** ⑨ directly. Make sure to protect the vehicle when using tools to apply pressure on the glue area.
12. Give the glue the opportunity to cure and check the integrity of the glue connection according to the installation procedure.

5 HOW TO USE THE PRODUCT

5.1 HOW TO OPERATE THE WINDOW

⚠ CAUTION

- Never open the window while driving.
- Always make sure the window is closed completely before driving.
- Make sure the sun blind and the insect screen are open before operating the window.

To open the window:

1. Push the lock button on the catch ⑥ with your thumb and turn the catch ⑥ 90 degrees, as indicated on the illustration.

NOTICE The side catches do not contain a lock button.

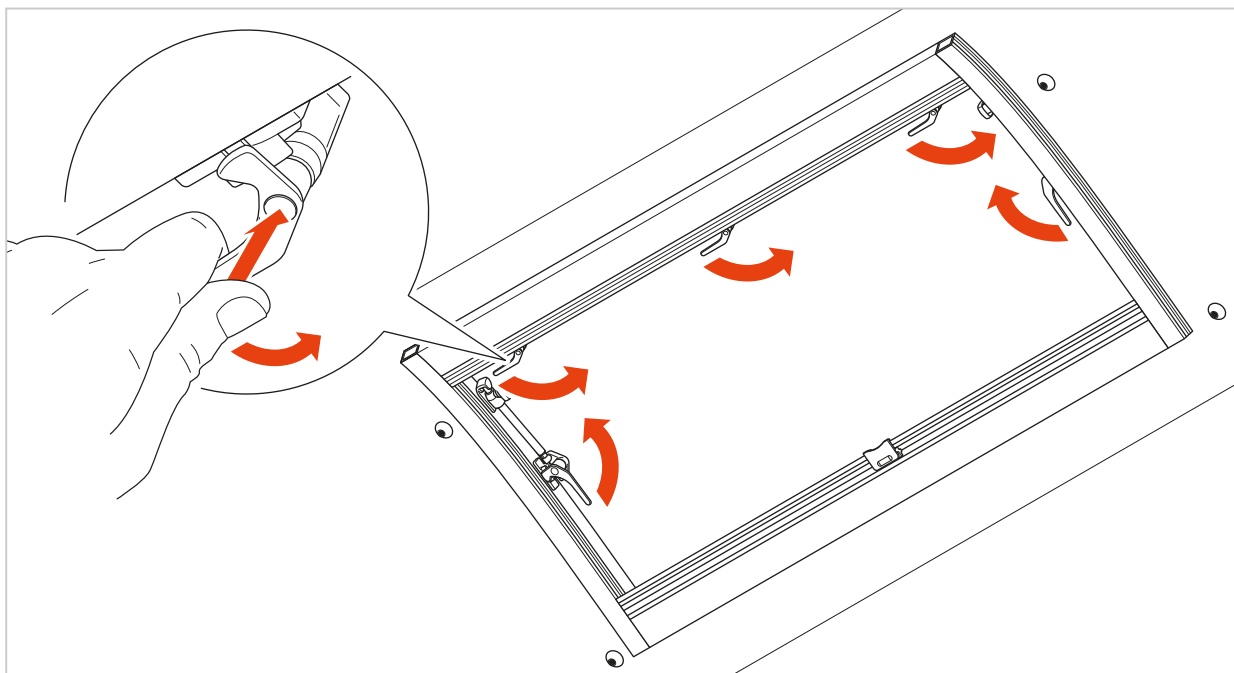

2. Push the window outwards, until you get the desired window opening.
NOTICE the window will hinge at the bottom.

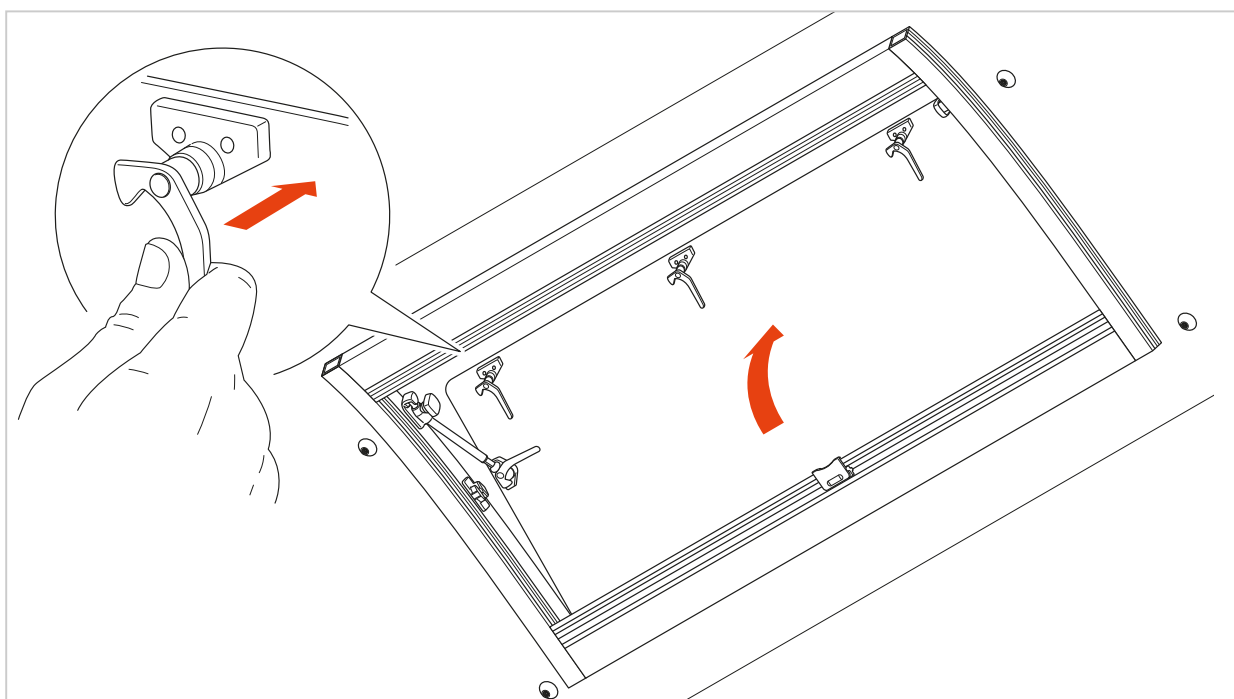

3. Turn the knob on one of the stays © clockwise until the window is secured, while keeping the window in position with the other hand.

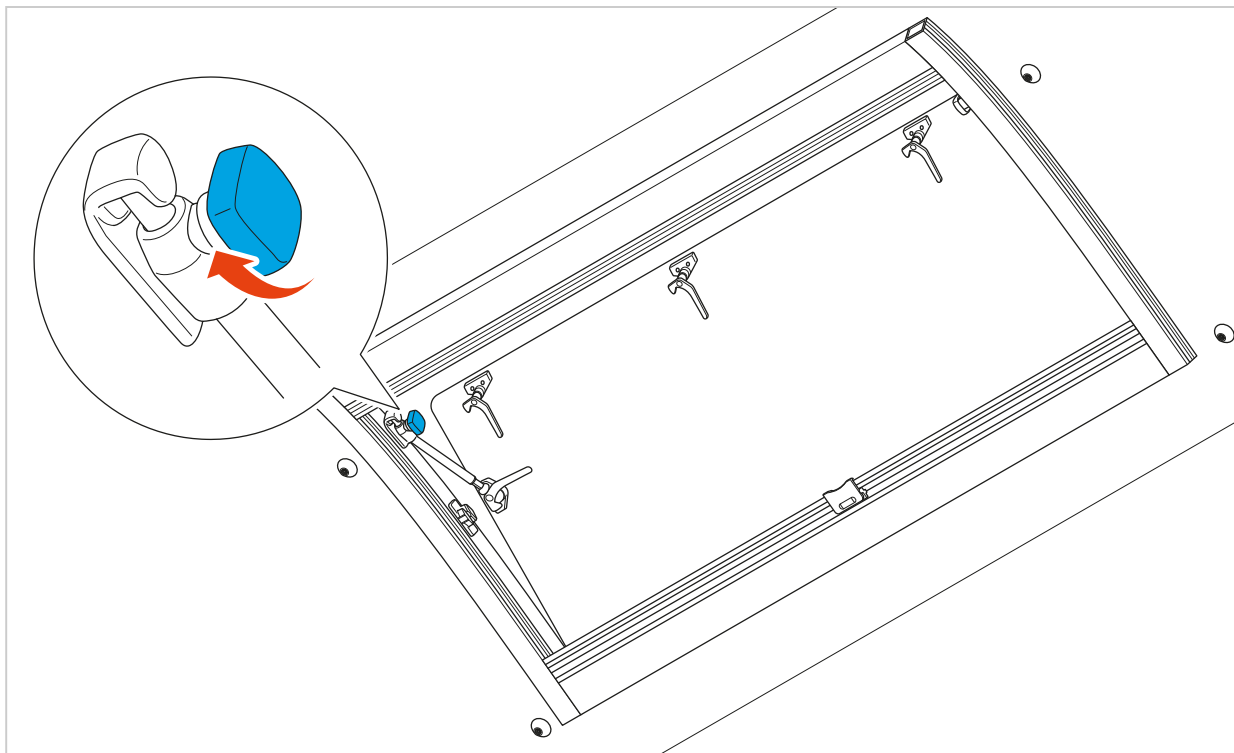

4. Turn the knob of the other stay © clockwise to fully secure the window.

To close the window:

- To close the window, follow the above steps in reverse order.
CAUTION! Always support the window with one hand when turning the knob of the second stay counterclockwise, to ensure a controlled closing of the window and to eliminate the risk of getting your hand or fingers caught in between the window and the frame.

5.2 HOW TO OPERATE THE PLEATED BLIND SYSTEM

The Vista is fitted with a pleated blind system which can be used as a sun blind or as an insect screen.

NOTICE

- Always open the window for ventilation when using the pleated blind system as a long-term sun blind on very hot days, to avoid the risk of damaging the window as a result of overheating.
- If the vehicle is stored for a longer period of time, the sun blind should not be closed.

To close the window:

- Pull the **top bar** downwards all the way until it snaps to the **bottom bar**. Always pull the bar in the middle, to avoid warping the sun blind.
NOTICE It is also possible to move both bars and thereby both the sun blind and insect screen at the same time.

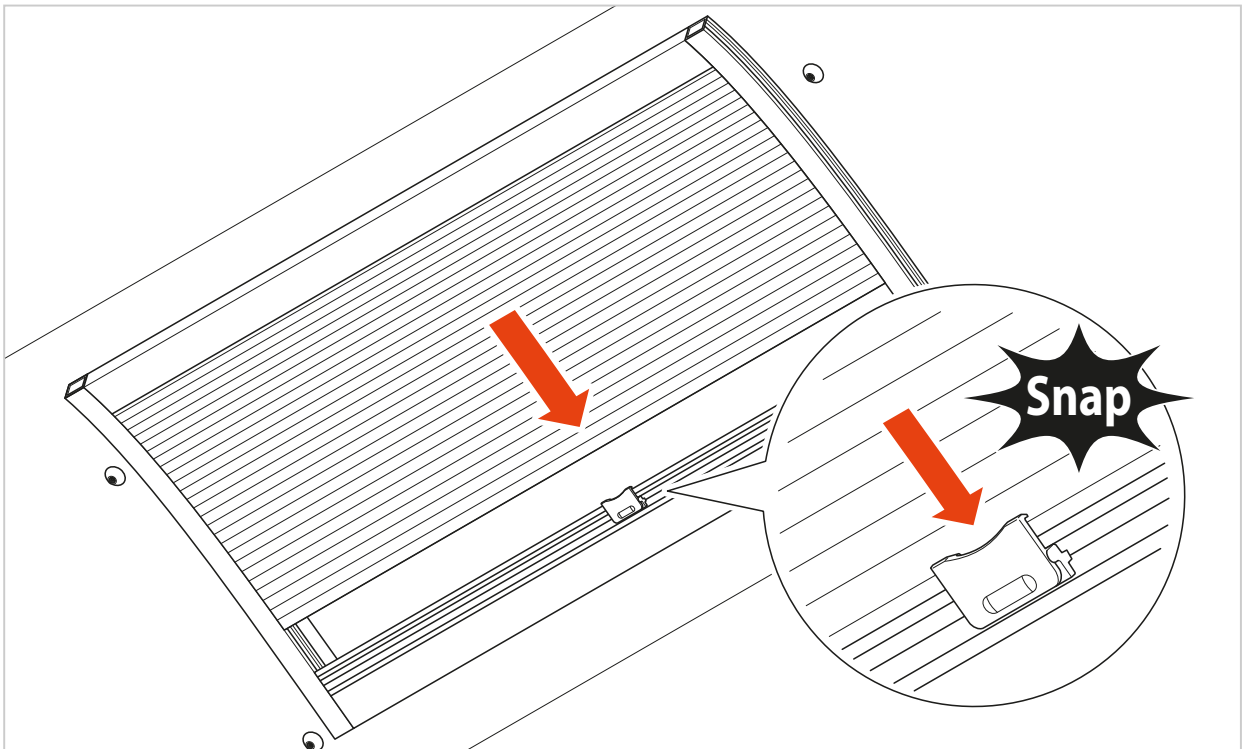

To use the insect screen:

- Pull the **bottom bar** upwards all the way until it snaps to the **top bar**. Always pull the bar in the middle, to avoid warping the insect screen.

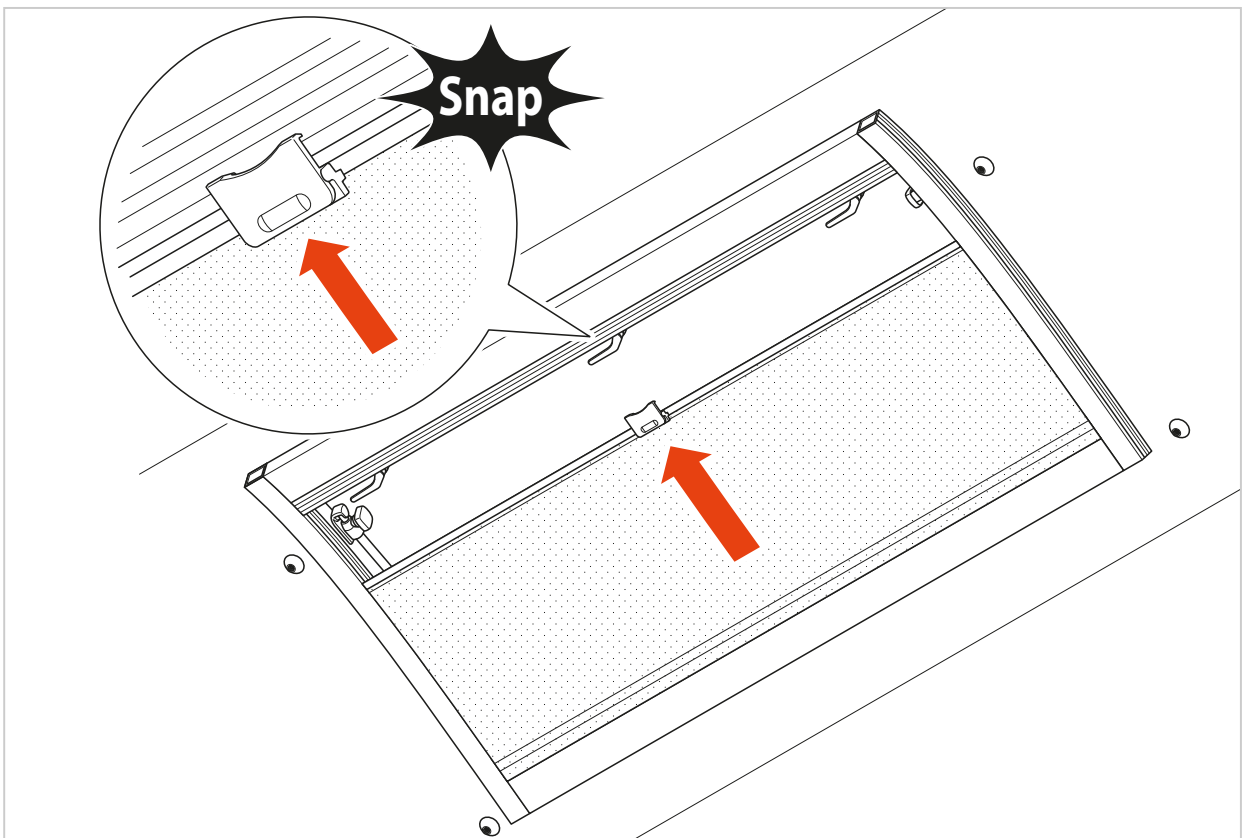

6 HOW TO MAINTAIN THE PRODUCT

6.1 PLANNED MAINTENANCE AND INSPECTION

Maintenance and inspection tasks shall be done according to the following plan:

PARTS	FREQUENCY
Cleaning the window (see 6.2)	Every month
Rubber maintenance (see 6.2)	Every 6 months
Inspection for scratches in acrylic (see 6.2)	Every week

6.2 HOW TO PERFORM MAINTENANCE TASKS

NOTICE

- Only use water and a neutral liquid soap to clean the window and the adapter. Hairline cracks in acrylic can only occur if your window comes into contact with a non- approved cleaning agent. If not adhered to, any warranty will be voided.
- Never use any scouring pads.
- Stains on the adapter can only occur when it comes into contact with a non- approved cleaning agent. If not adhered to, any warranty will be voided.
- Never use high pressure jets for cleaning the window or the adapter.
- Never use any agents containing silicones for maintaining the rubber.
- In case of condensation in between the acrylic panes of the window, please contact your dealer. The window might be damaged.
- Acrylic and Polyurethane are susceptible to UV discolouration. Therefore, colour differences may occur when replacing a component.

To clean the window:

- Clean the window with a soft, clean sponge using only a neutral liquid soap in a bucket of lukewarm water. Do not use any scouring pads.

To maintain the rubber:

- Apply talcum powder on the rubber to avoid wear and tear.

To inspect and repair scratches in the window:

- Carefully inspect the inside and outside of the window to check for any scratches. Shallow scratches in the acrylic can be removed using the Polyplastic Acrylic Polish that is available at your dealer (*Item no. 09.00.880.00.00.01.000*). For deeper scratches in the acrylic please refer to your dealer or a certified specialist.

APPENDIX

I. TECHNICAL DATA

PARTS	FREQUENCY
Product name	Vista
Type/Model	Roof window for H2 vehicles on a X290 platform
Product Size L x W x H	1481 x 846 x 160 mm
Product Weight	15 kg
Aperture Size L x W	1270 x 660 mm
Aperture Corner radii	60 mm
Material of window	Cast acrylic
Material of adapter	Polyurethane
Ambient operating temperature range	-10 °C to +50 °C
Ambient operating humidity range	0 - 98%

EN

II. PRODUCT ELEMENTS

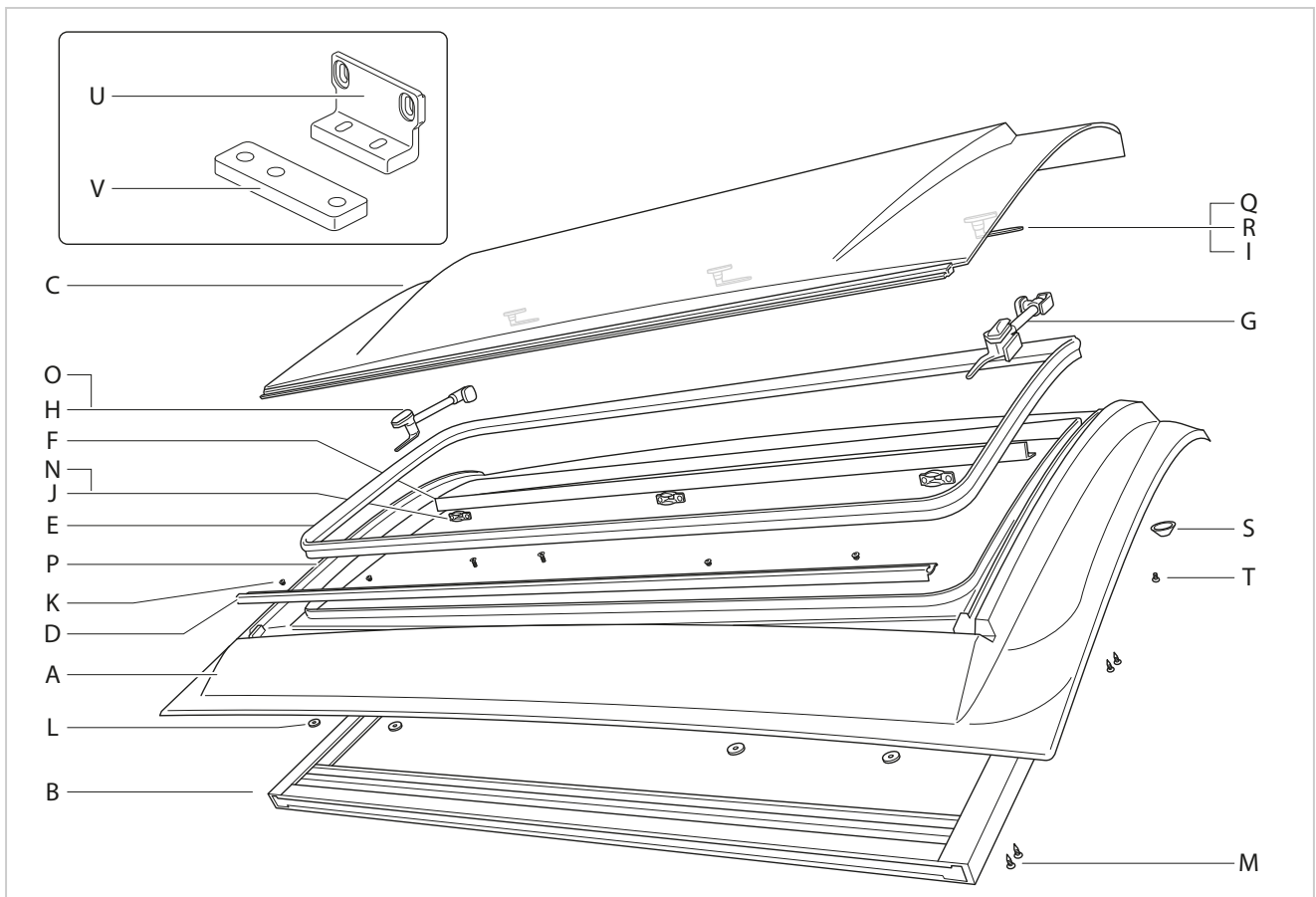

ITEM	PART	AMOUNT	REPLACEABLE	IN COMBINATION WITH	ARTICLE NUMBER	OPENABLE VERSION	FIXED VERSION
A	Adapter	1	Yes	complete product	09.35.010.00.00.00.000	Yes	Yes
B	Pleated blind system	1	Yes	-	09.35.000.00.01.00.000	Yes	Yes
C	Window (+hinge bar)	1	Yes	-	04.90.248.90.61.96.000	Yes	Yes
D	Upper hinge bar	1	Yes	complete product	09.00.583.06.12.04.250	Yes	Yes
E	Rubber	3,5 mm	Yes	-	09.35.600.00.03.00.000	Yes	Yes
F	Fixation L-bracket	1	Yes	-	09.35.000.00.05.02.000	No	Yes
G	Stay left	1	Yes	-	09.00.150.00.00.01.000	Yes	No
H	Stay right	1	Yes	-	09.00.151.00.00.00.000	Yes	No
I	Catch	3	No	-	09.10.451.00.00.00.000	Yes	No
J	Lockplates	5	Yes	-	09.00.811.00.00.00.000	Yes	No
K	Rivets	4	Yes	-		Yes	Yes
L	Washer M5	4	Yes	-		Yes	Yes
M	Screw pleated blind - 4,0 x 20	8	Yes	-	09.35.000.00.04.02.000	Yes	Yes
N	Screw lockplates - 3,9 x 16 (Fixation L-bracket)	6	Yes	-	09.35.000.00.04.01.000	Yes	Yes
O	Screw stays - 4,2 x 13	4	Yes	-	09.35.000.00.04.04.000	Yes	No
P	Screw top hinge bar - 3,5 x 12	2	Yes	-		Yes	Yes
Q	Screw catch 3,5 x 14	10	Yes	-	09.00.999.00.05.42.000	Yes	Yes
R	Rubber pads	5	Yes	-	09.00.999.00.03.14.000	Yes	Yes
S	Fixation cone	4	Yes	-	09.35.000.00.05.40.000	Yes	Yes
T	Fixation screw	4	Yes	-	09.35.000.00.05.41.000	Yes	Yes
U	L-fixation bracket	5	Yes	-	09.00.827.00.00.00.000	No	Yes
V	Fill plate	5	Yes	-	09.00.814.00.00.00.000	No	Yes



Copyright © 2021 by Polyplastic

All rights reserved. No part of this publication shall be reproduced, distributed, or transmitted in any form or by any means, including photocopying, recording, or other electronic or mechanical methods, without the prior written permission of the publisher. For permission requests, write to the publisher, addressed "Attention: Permissions Coordinator," at the address below.